

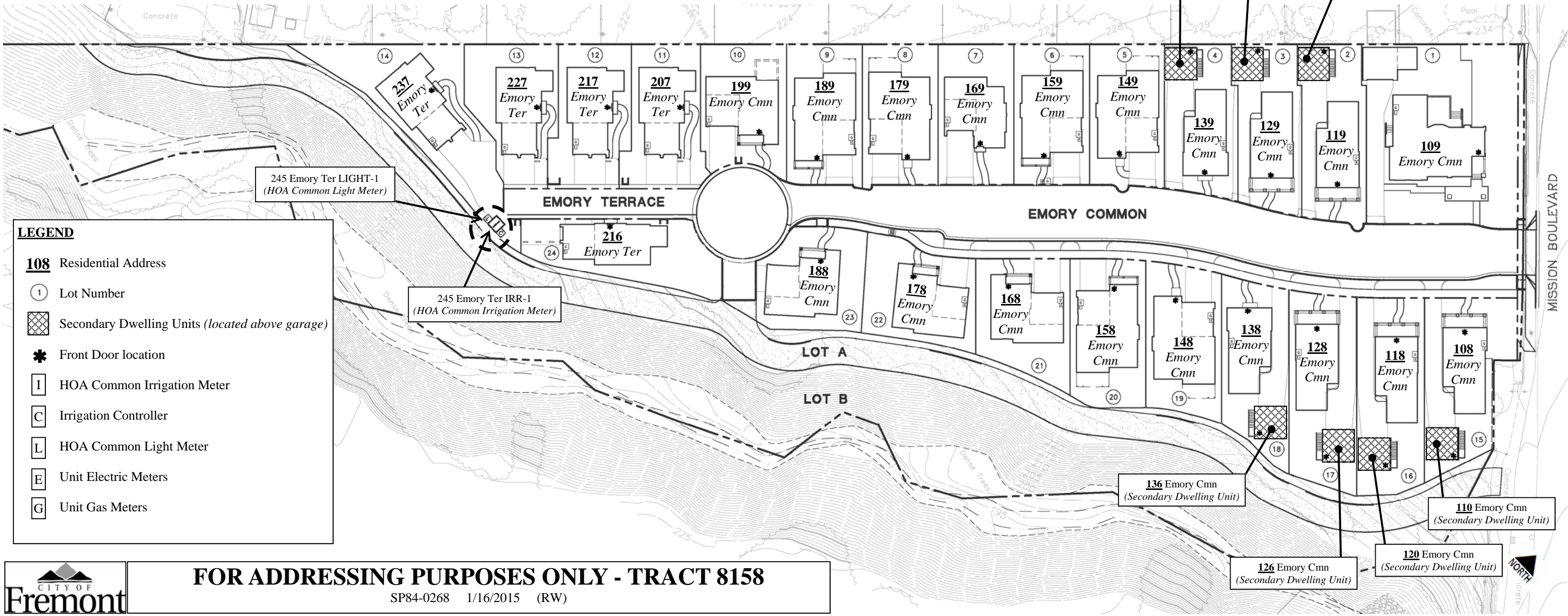

ADDRESS CHRONOLOGY

- Original addressing at time of initial development: 1918
- Addressing action for Tract 8158 (Emory Common and Emory Terrace): 1/16/2015 (RW)
 - Address assignment for twenty-four new single family homes, seven secondary dwelling units and two HOA Utility Meters.
 - Original address (42425 Mission Blvd) rescinded.



131 Emory Cmn
(Secondary Dwelling Unit)

121 Emory Cmn
(Secondary Dwelling Unit)

141 Emory Cmn
(Secondary Dwelling Unit)

245 Emory Ter LIGHT-1
(HOA Common Light Meter)

245 Emory Ter IRR-1
(HOA Common Irrigation Meter)

136 Emory Cmn
(Secondary Dwelling Unit)

110 Emory Cmn
(Secondary Dwelling Unit)

126 Emory Cmn
(Secondary Dwelling Unit)

120 Emory Cmn
(Secondary Dwelling Unit)

