

WARM SPRING BOULEVARD

BROWN ROAD

WOODVIEW COMMON

WOODVIEW TERRACE

46196 Warm Springs Blvd  
BUILDING A

Situs and Common Area  
46100 Warm Springs Blvd

ADDRESSING CHRONOLOGY:  
(1) 1974: Addresses (46100 and 46408 Warm Springs Boulevard) issued for original commercial development.  
(2) 10/1/2008: Rescind 46408 Warm Springs Boulevard; and reassign 46100 Warm Springs Boulevard as Common Area and Situs address. Issue (77) addresses for new commercial condo development.

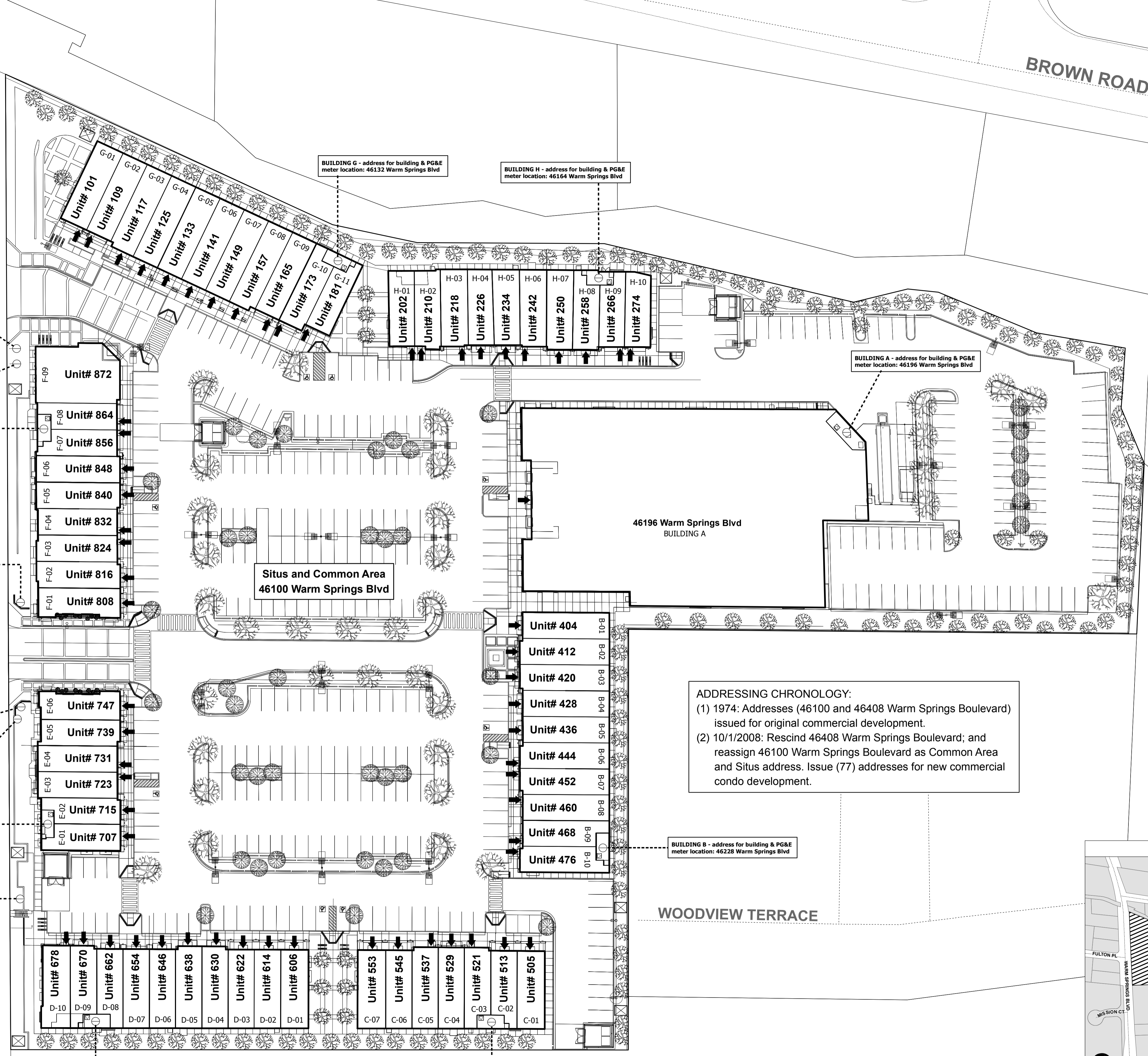
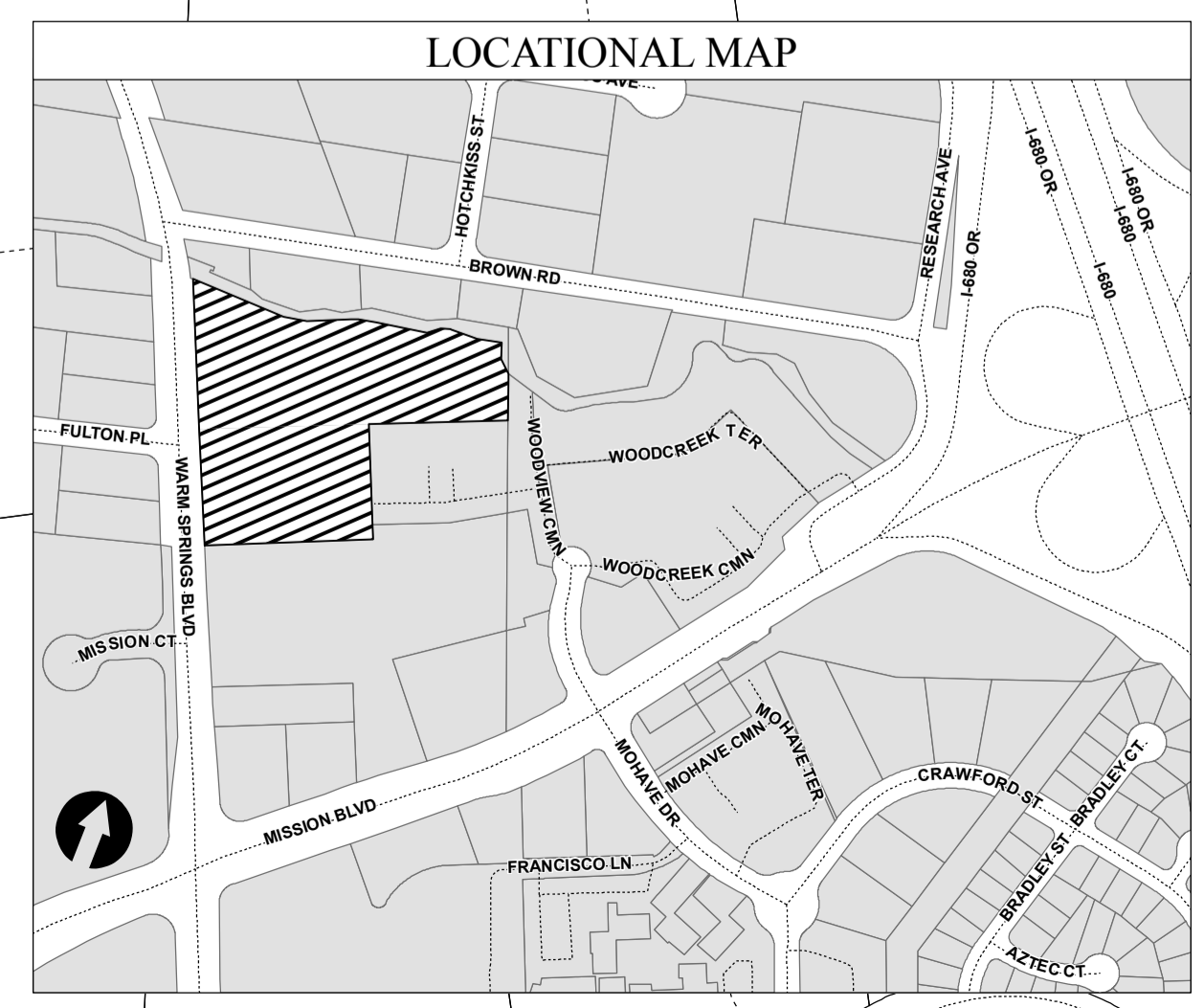

BUILDING G - address for building & PG&E meter location: 46132 Warm Springs Blvd

BUILDING H - address for building & PG&E meter location: 46164 Warm Springs Blvd

BUILDING A - address for building & PG&E meter location: 46196 Warm Springs Blvd

BUILDING F - address for building & PG&E meter location: 46356 Warm Springs Blvd

Building Water Meter #1  
46360 Warm Springs Blvd

Building Water Meter #2  
46366 Warm Springs Blvd

Monument Sign 1  
46372 Warm Springs Blvd

Monument Sign 2  
46378 Warm Springs Blvd

Irrigation Water Meter  
46384 Warm Springs Blvd

BUILDING E - address for building & PG&E meter location: 46324 Warm Springs Blvd

Building Water Meter #3  
46390 Warm Springs Blvd

BUILDING D - address for building & PG&E meter location: 46292 Warm Springs Blvd

BUILDING C - address for building & PG&E meter location: 46260 Warm Springs Blvd

BUILDING B - address for building & PG&E meter location: 46228 Warm Springs Blvd