

Addressing Chronology:

- (1) New addresses issued at the time of construction, 12/11/1995.
- (2) New tenant space addresses issued for Bldg. D, 8/30/1999.
- (3) New/Revised tenant space addresses for Bldg. A, 10/27/2004.
- (4) Two new tenant space addresses issued for Bldg. M, 5/28/2009;
and new PG&E meter address issued for Bldgs. B, C and M,

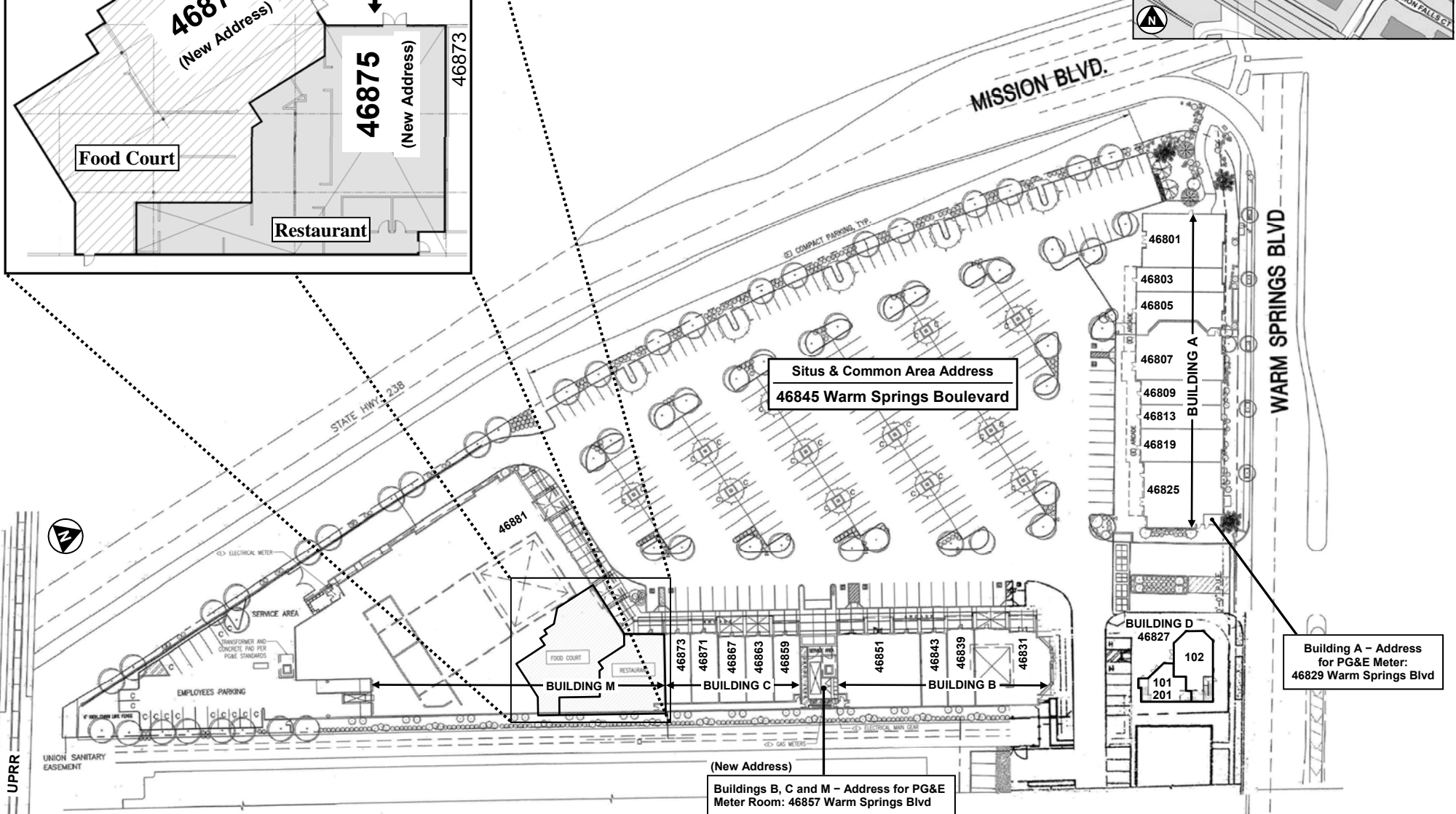
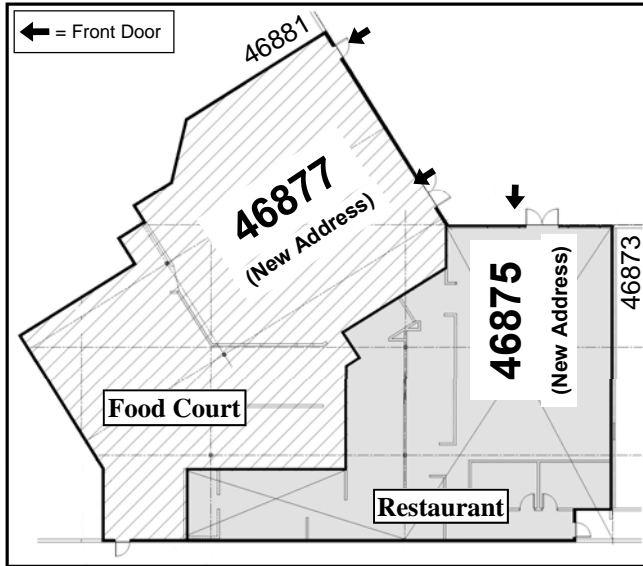

Note: All address numbers are assigned to Warm Springs Boulevard.

(New Address)
Buildings B, C and M - Address for PG&E
Meter Room: 46857 Warm Springs Blvd

Building A - Address
for PG&E Meter:
46829 Warm Springs Blvd