

**LOCATIONAL MAP**

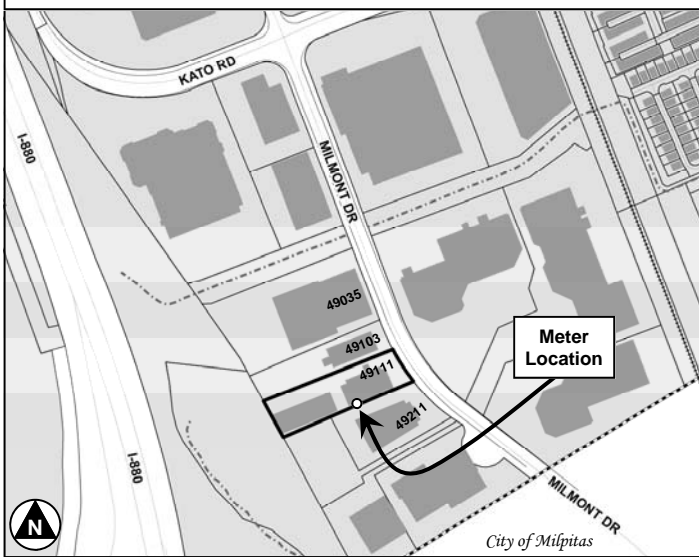

**FOR ADDRESSING PURPOSES ONLY**  
 SP84-0108 3/15/2010 RC

**Addressing Chronology:**

- (1) Situs address, 49111 Milmont Drive, issued at the time of initial construction in 1984.
- (2) Additional addresses, 49117-49151 Milmont Drive, issued on May 20, 1986.
- (3) Nextel PG&E meter address, 49165 Milmont Drive, issued on October 16, 1995.
- (4) Clearwire PG&E meter address, 49163 Milmont Drive, issued on March 15, 2010.

**Clearwire Meter Location  
 49163 Milmont Drive  
 (new address)**

**DETAILED  
 SITE PLAN**

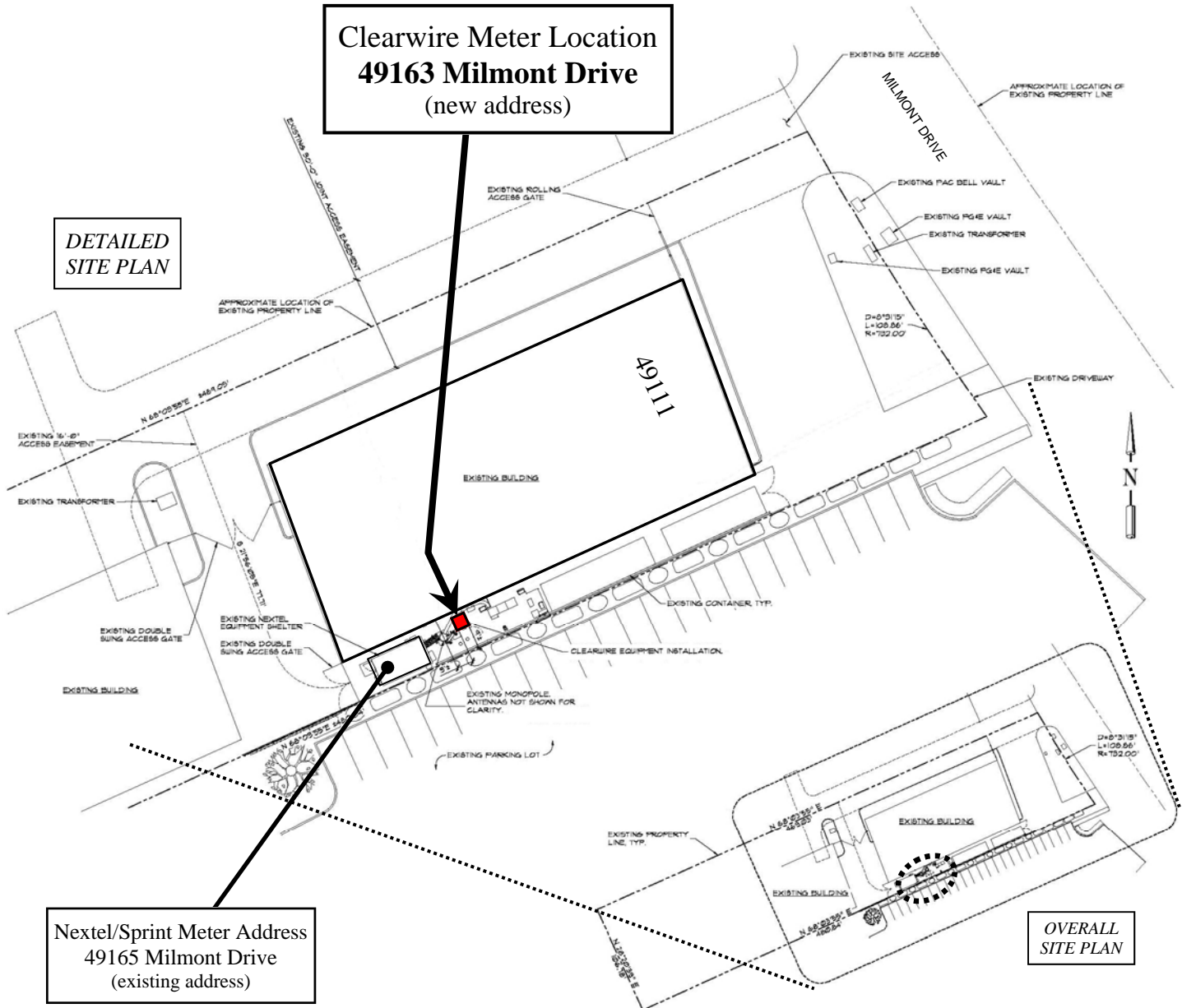

**Nextel/Sprint Meter Address  
 49165 Milmont Drive  
 (existing address)**

**OVERALL  
 SITE PLAN**