

CONDITION OF APPROVAL: Prior to final inspection, Wayfinding signage and/or floor plans shall be posted on each residential floor to clearly indicate the unit numbers and flow direction. Appropriate signage and/or floor plan shall be placed near the elevators and/or stairs as well as midpoint of hallway. Subject to the approval of the Fremont Fire Marshal.



 **LOCATIONAL MAP**

Legend

 Elevator

OVERALL SITE PLAN

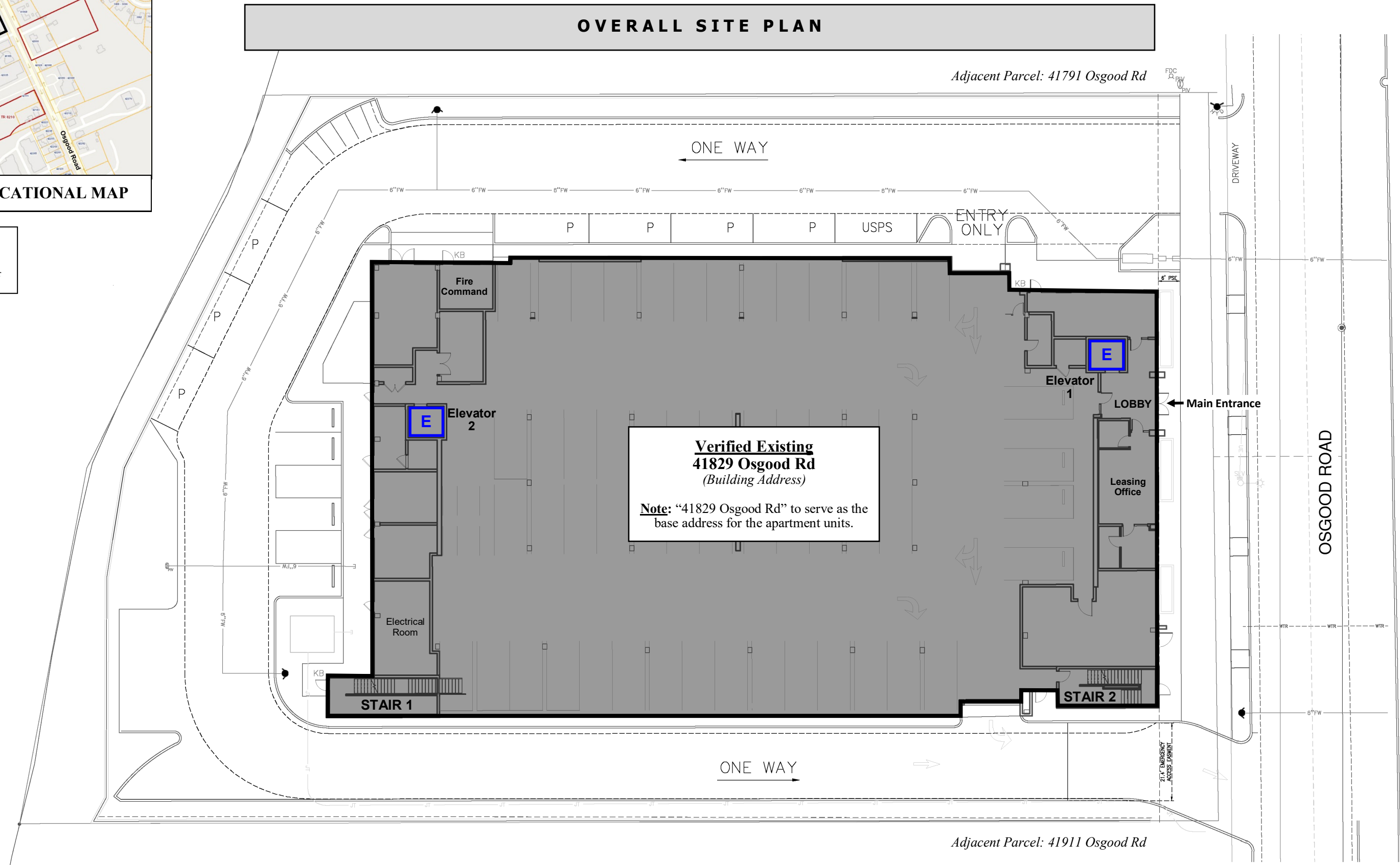

FOR ADDRESSING PURPOSES ONLY — Page 1 of 8

SP78-0240 4/25/2022 (RC)

ADDRESS CHRONOLOGY

- Parcel addresses issued at time of initial development: 1956
- Addresses issued to residential building: 4/25/2022 (RC)

RESIDENTIAL UNIT SUMMARY PLAN

Verified Existing
41829 Osgood Rd
(Apartment Base Address)

Legend



Elevator

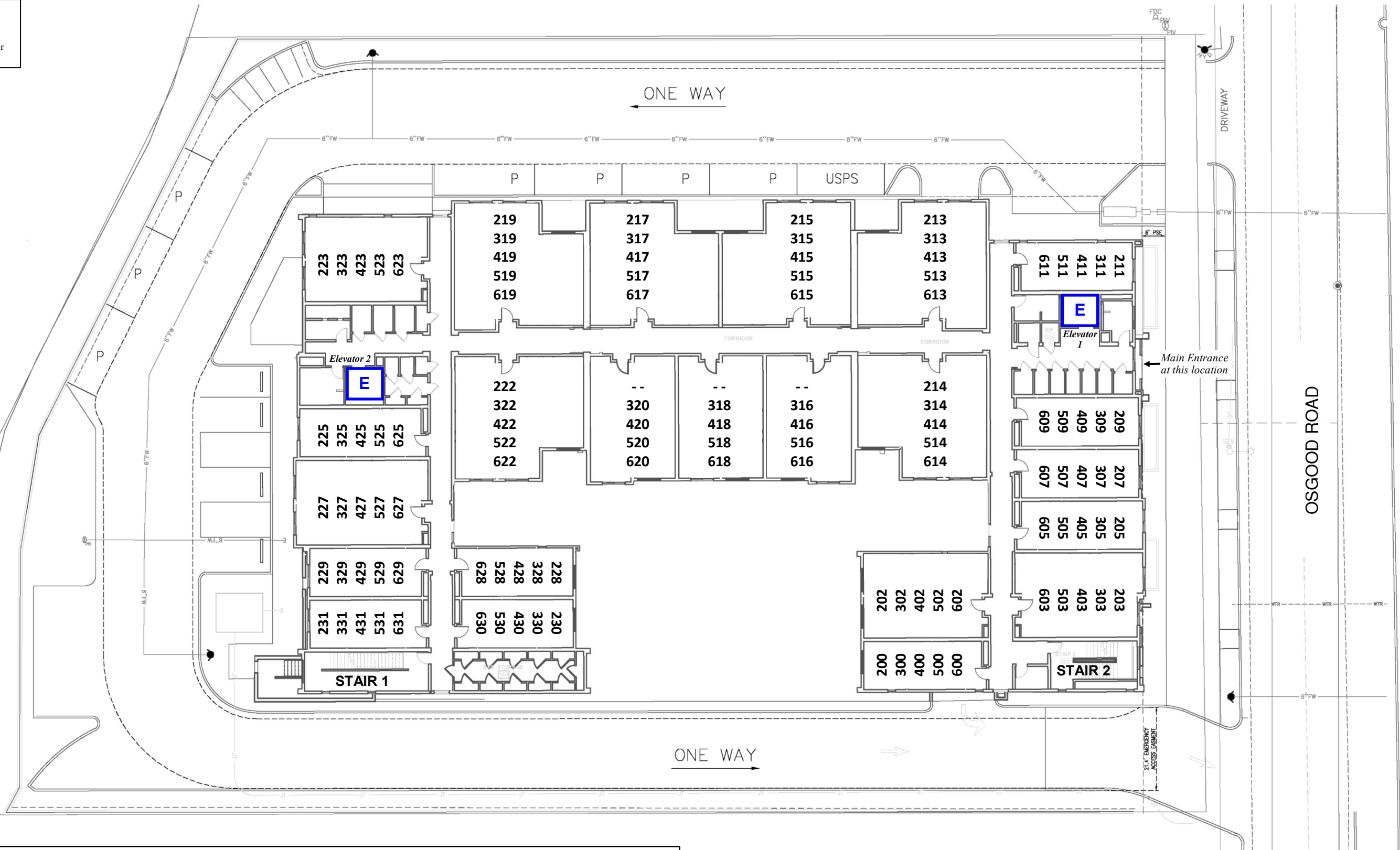

FLOOR 1 (Ground Level)

Verified Existing
41829 Osgood Rd
(Building Address)

Legend

E Elevator

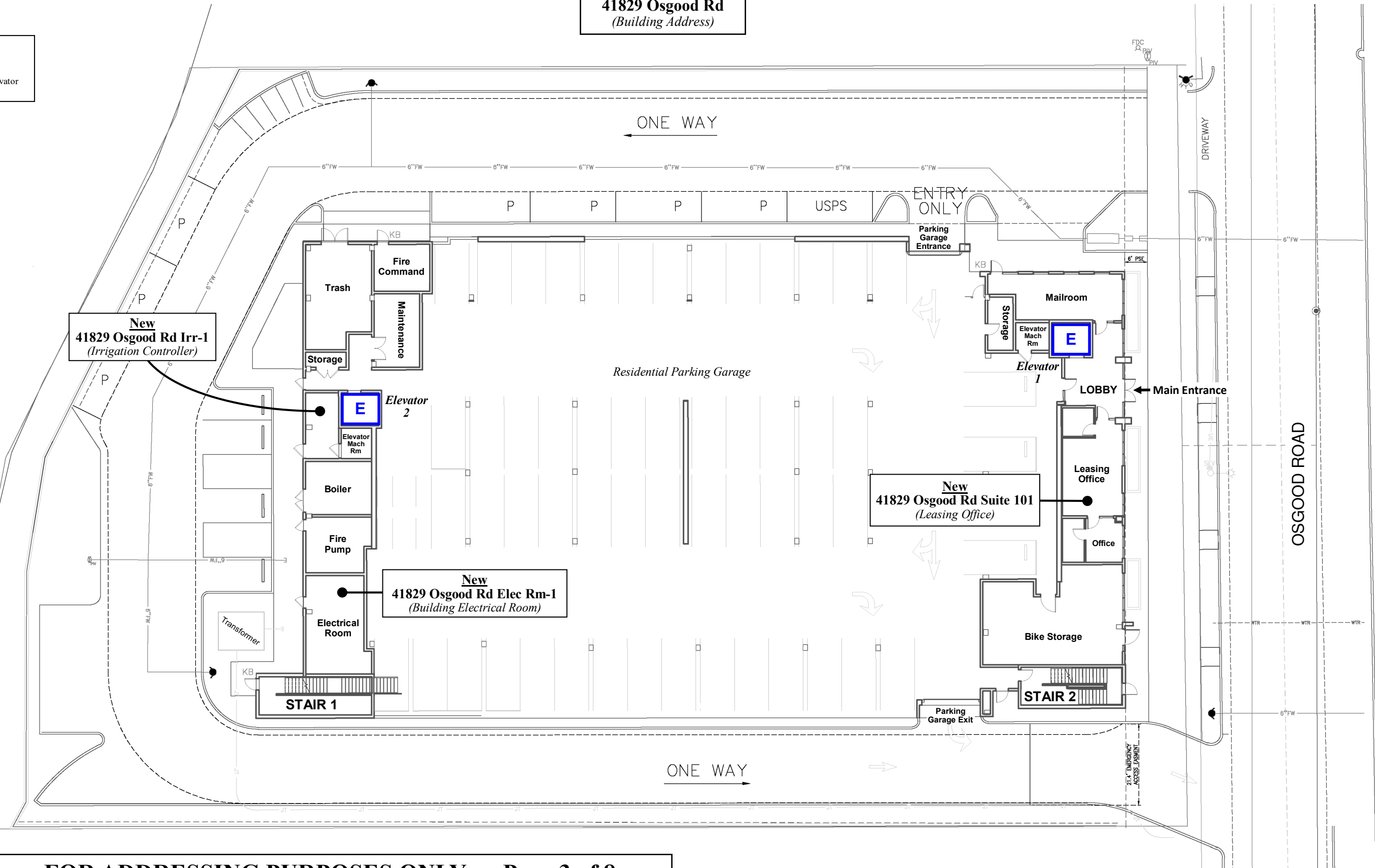

FLOOR 2

Verified Existing
41829 Osgood Rd
(Apartment Base Address)



FLOOR 3

Verified Existing
41829 Osgood Rd
(Apartment Base Address)



FLOOR 4

Verified Existing
41829 Osgood Rd
(Apartment Base Address)



FLOOR 5

Verified Existing
41829 Osgood Rd
(Apartment Base Address)



FLOOR 6

Verified Existing
41829 Osgood Rd
(Apartment Base Address)

