



Date: January 16, 2020

To: Alexander Leung
 38601 Chapman Ct
 Fremont, CA 94536

Requestor: JCONN
 Discretionary Rev: PLN2019-00272
 Permitting File#: BLD2019-04564
 SP#: 72-0358
 APN#: 507 043019000
Zip Code: 94536
 Fire ESZ | Box/S-Dist: 09 – 480 | 9-2 / 89A7
Address For: Residence

Re: Address for Accessory Dwelling Unit – 38601 Chapman Ct, Unit A

To Whom It May Concern:

In response to your request for an address needed for a new accessory dwelling unit, one (1) new address has been assigned. For a full inventory and description of the new and existing addresses, please refer to Table “A”. The enclosed Addressing Plan illustrates the proper use and placement of the new address.

Electronic copies of this letter and documentation will be posted to the City’s web site at http://gis.ci.fremont.ca.us/addr/addr_proj.cfm within 10 business days. The files will be stored under SP72-0358.

Documents available on Web Site:

X	Notification Letter		Address Table
X	Address Plan (map)		G.I.S. Layer
	AutoCAD Drawing		

In accordance with Title 15 (Buildings and Construction) Chapter 15.55 (House Numbering) of the Fremont Municipal Code, this letter serves as the notice of the addressing action affecting your property. The new address must be in use within ten (10) days of the receipt of this letter. For information on the size and location of address numbers on a building, please refer to the enclosed information sheet titled “ADDRESSING – Property Owner Responsibilities” and to Chapter 15.50 (Building Security) of the Title 15 (Buildings and Construction).

You will need to update your address records and outside address numbers as soon as possible for the purpose of rapid identification of your property in the event of an emergency. Any occupants and property owner of this parcel should review and update their records that are registered with the City (such as for building permit and/or business tax purposes). And, by copy of this letter, we are notifying the below-listed agencies and utility companies. However, be aware that some agencies may not update

Alexander Leung
January 16, 2020

Page 2 of 3

their records until notified by the property owner. Therefore, it is your responsibility to make sure that the appropriate agencies or businesses acknowledge the correct addresses.

If you have any questions concerning this matter, please contact Ron Chan at (phone) 510-494-4832 or (e-mail) rchan@fremont.gov.

Sincerely,

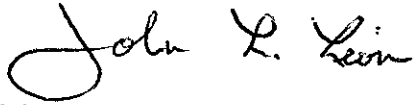

John L. Leon
GIS and Addressing Manager (Interim)

Enclosures (hardcopy/paper): Address Plan - map (1) and Property Owner Responsibilities Information Sheet.

cc: **Paper copy mailed to:**

Alameda County Assessor's Office
Alameda County Registrar of Voters
Alameda County Water District (2)
Alameda County 911 (Coordinator)
Alameda County Main Post Office (AMS Manager)
Republic Services (Customer Service Manager)
Fremont Main Post Office (Station Manager) – zip code area 94536 / 94537 / 94555
US Postal Service / AMS (AMS Tech)
Fremont Unified School District (Facilities Director)
Lynx Technologies
Pacific Gas & Electric (Service Planning Dept.) (2)
AT&T – Engineering
Union Sanitary District (2)

Sent via e-mail:

Alameda County Regional Emergency Communication Center - Dublin (Joshua Harris)
AT&T – Database Center / SLIC
Cooperative Strategies/Dolinka Group (Andrew Bishop)
Fremont Community Development – Building & Safety (Gary West)
Fremont Community Development – Fire & Life Safety (Howard Hancock)
Fremont Plans & Permits
Fremont GIS (Ruby Wun)

LOCATIONAL MAP

(For reference only – see official addressing map for actual/correct address)

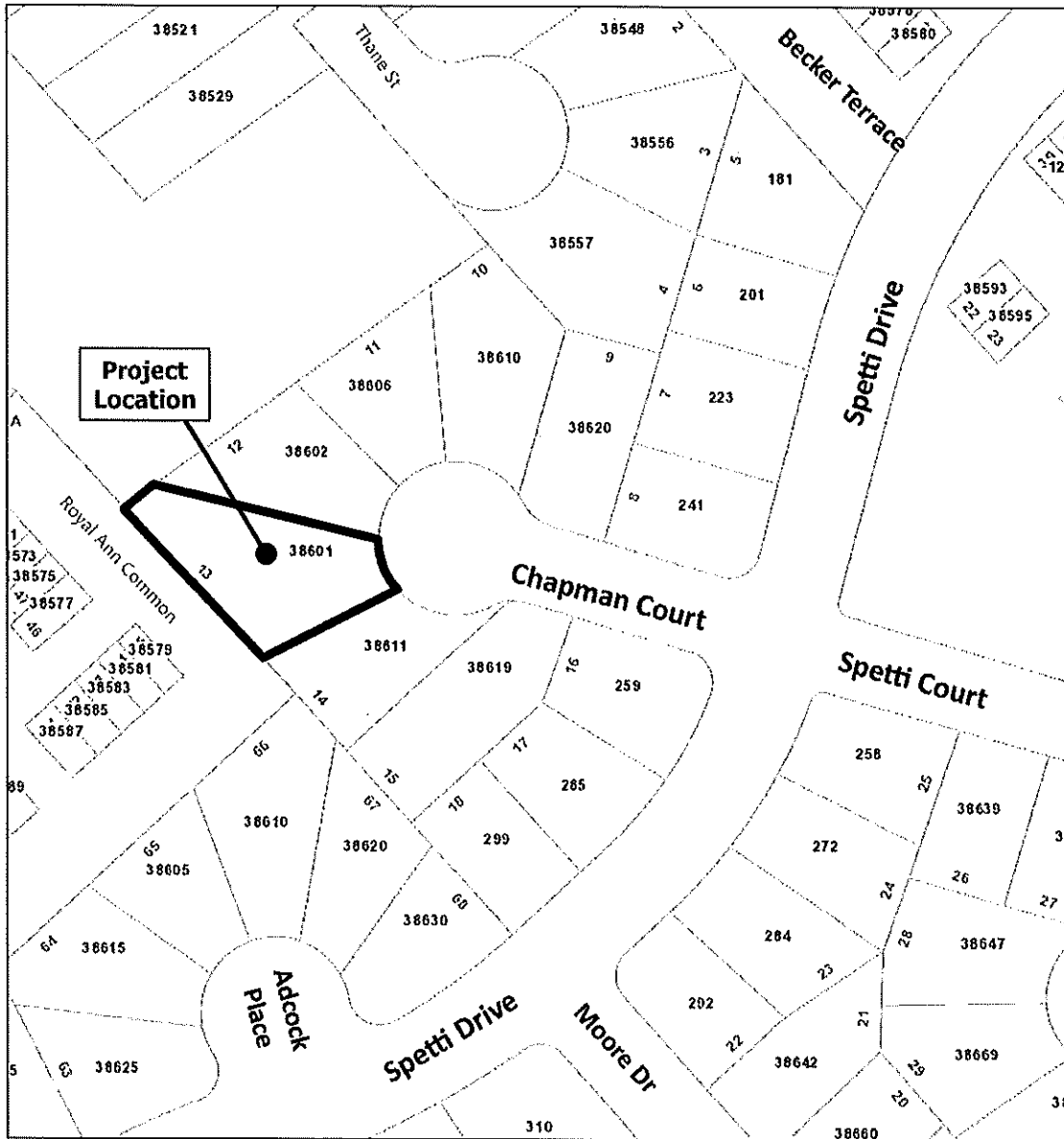

TABLE A: Authorized Addresses

Record	Address No.	Street Name	Unit No.	Zip Code	Bldg	Floor	Subdivision No.	Land Lot	Condo Lot	Address Type	Address Status
1	38601	Chapman Ct		94536			TR 3672	Lot 13		Property/Situs	Verified Existing
2	38601	Chapman Ct	Unit A	94536			TR 3672	Lot 13		Accessory Dwelling Unit	Assigned