

FULL ADDRESS				Building	Address Type	STATUS
Record	Address No.	Street Name	Zip Code			
1	39754	Stevenson Pl	94539	Maintenance Bldg. (Golf Course/Driving Range)	NRES   INST	Existing
2	39751	Stevenson Pl	94539	Golf Course/Driving Range	NRES   INST	Existing
3	39609	Stevenson Pl	94539	Fire Station No. 9	NRES   INST	Existing
4	350	Stevenson Blvd	94538	Underground Service	NRES   INST	Existing
5	420	Stevenson Blvd	94538	Pump House (Park East Well #3)	MISC   UTIL	Existing
6	780	Stevenson Blvd	94538	Tennis Court Restrooms	NRES   INST	Existing
7	790	Stevenson Blvd	94538	Tennis Pro Shop/Center - Utility Address	NRES   INST	Existing
8	1110	Stevenson Blvd	94538	Tennis Pro Shop/Center, Softball Complex, Sports Storage Bldg, Snack Bar and Sand & Volley Ball Court	NRES   INST	Existing
9	820	Stevenson Blvd	94538	Soccer Complex Restrooms	NRES   INST	Existing
10	850	Stevenson Blvd	94538	Fabbri Field Restrooms	NRES   INST	Existing
11	860	Stevenson Blvd	94538	Fabbri Field Snack Bar	NRES   INST	Existing
12	2000	Stevenson Blvd	94538	Police Building	NRES   INST	Existing
13	1996	Stevenson Blvd	94538	Police Shooting Range Bldg	NRES   INST	Existing
14	1990	Stevenson Blvd	94538	Police Detention Facility	NRES   INST	Existing
15	1980	Stevenson Blvd	94538	Police Property Storage Facility	NRES   INST	Existing
16	1970	Stevenson Blvd	94538	Police Fueling Station	NRES   INST	Existing
17	1950	Stevenson Blvd	94538	Animal Shelter	NRES   INST	Existing
18	39700	Civic Center Dr	94538	Demolished City Hall	NRES   INST	Existing
19	2400	Stevenson Blvd	94538	Fremont Main Library	NRES   INST	Existing
20	2450	Stevenson Blvd	94538	Alameda Co. Library Administration	NRES   INST	Existing
21	39770	Paseo Padre Pkwy	94538	Teen Center	NRES   INST	Existing
22	39800	Paseo Padre Pkwy	94538	Central Park Service Center	NRES   INST	Existing
23	40042	Paseo Padre Pkwy	94538	Traffic Signal Cabinet (Paseo Padre Pkwy & Sailway Dr)	MISC   TRAF	Existing
24	39780	Paseo Padre Pkwy	94538	Sailway Drive Restrooms	NRES   INST	Existing
25	40000	Paseo Padre Pkwy	94538	Central Park Boathouse/Visitor Center	NRES   INST	Existing
26	40016	Paseo Padre Pkwy	94538	Boathouse Storage Bldg	NRES   INST	Existing
27	40010	Paseo Padre Pkwy	94538	Boathouse Lift Station	NRES   INST	Existing
28	40050	Paseo Padre Pkwy	94538	Boathouse Snack Bar	NRES   INST	Existing
29	40070	Paseo Padre Pkwy	94538	Lions Area Restrooms	NRES   INST	Existing
30	40086	Paseo Padre Pkwy	94538	Senior Center	NRES   INST	Existing
31	40204	Paseo Padre Pkwy	94538	Fremont Community Center Band Pavillion	NRES   INST	Existing
32	40400	Paseo Padre Pkwy	94538	Kennedy Play Area Restrooms	NRES   INST	Existing
33	40216	Paseo Padre Pkwy	94538	Babbling Brook Pump House (north of Water Park/west of Nature Learning Center)	MISC   UTIL	Existing
34	40210	Paseo Padre Pkwy	94538	Babbling Brook Restroom	NRES   INST	Existing
35	40200	Paseo Padre Pkwy	94538	5 Palms Restrooms (near Water Park)	NRES   INST	Existing
36	40500	Paseo Padre Pkwy	94538	Water Park (Future) Skate Park	MISC   UTIL	Existing
37	40600	Paseo Padre Pkwy	94538	Natural Science Center & Boardwalk (Stivers)	NRES   INST	Existing
38	40640	Paseo Padre Pkwy	94538	PG&E Meter (east Of Science Center)	MISC   UTIL	Existing
39	40710	Paseo Padre Pkwy	94538	Pump House	MISC   UTIL	Existing
40	40700	Paseo Padre Pkwy	94538	Signal Box No. 1	MISC   TRAF	Existing
41	40730	Paseo Padre Pkwy	94538	Signal Box No. 2	MISC   TRAF	Existing
42	40708	Paseo Padre Pkwy	94538	Pump House (Washington Blvd & Paseo Padre Pkwy Project)	MISC   UTIL	Existing
43	40224	Paseo Padre Pkwy	94538	Nature Learning Center	NRES   INST	Existing
44	1320	Stevenson Blvd	94538	BART Extension Construction Trailer and Temporary Power Service (Temporary)	MISC   TRLR	Existing
45	40680	Paseo Padre Pkwy	94538	Catholic Protection Station	MISC   UTIL	Existing
46	40690	Paseo Padre Pkwy	94538	BART Ventilation Structure "LES"	MISC   UTIL	Existing
47	40726	Paseo Padre Pkwy	94538	Traction Power Substation "SPP"	MISC   UTIL	Existing
48	1260	Stevenson Blvd	94538	Ventilation Structure "CPS"	MISC   UTIL	Existing
49	1944	Stevenson Blvd	94538	Meter serving Central Park Well # 2; PG&E Meter # T56906	MISC   UTIL	Existing
50	1946	Stevenson Blvd	94538	Meter serving Central Park Well # 1; PG&E Meter # 43T973	MISC   UTIL	Existing
51	2290	Stevenson Blvd	94538	Meter serving Civic Center Drive Parking Lot	MISC   UTIL	NEW

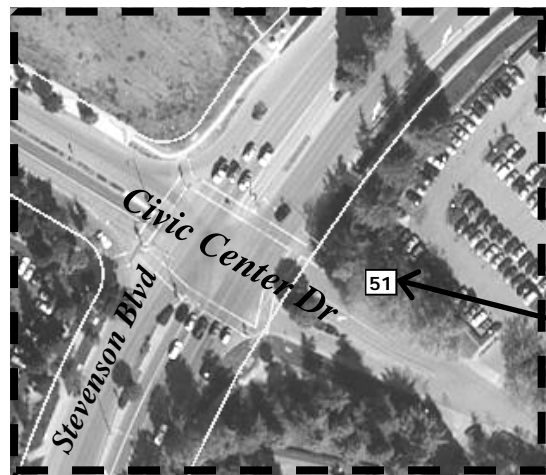

**NEW**  
2290 Stevenson Blvd  
(Utility meter for parking lot pole lights)

**SYMBOLS LEGEND**  
 RESTROOMS  
 PARKING  
 PICNIC AREA

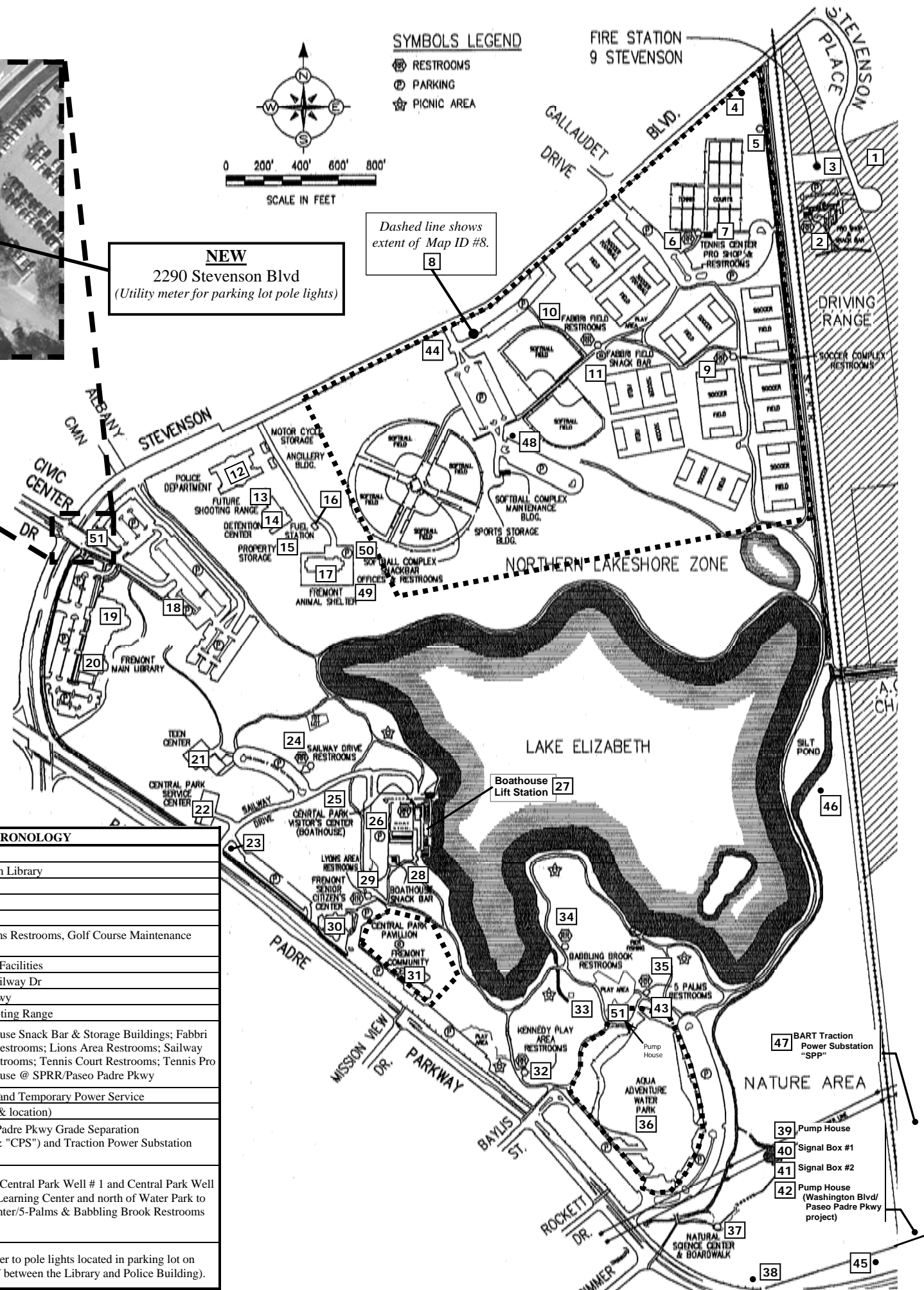

ADDRESSING CHRONOLOGY	
Prior 1986	Original addressing
1986	Animal Shelter, Administration & Main Library
1988	Softball Fields
1990	Fire Station No. 9
1994	Police Building
2000	Police Building Fueling Station, 5 Palms Restrooms, Golf Course Maintenance Building; Sport Storage Building
2001	Police Detention and Property Storage Facilities
2005	Traffic Signal @ Paseo Padre Pkwy/Sailway Dr
2006	Pump House @ SPRR/Paseo Padre Pkwy
2007	Signal Box No. 1 & No. 2; Police Shooting Range
2008	Babbling Brook Pump House; Boat House Snack Bar & Storage Buildings; Fabbri Field Snack Bar; Kennedy Play Area Restrooms; Lions Area Restrooms; Sailway Drive Restrooms; Soccer Complex Restrooms; Tennis Court Restrooms; Tennis Pro Shop/Center Utility Address; Pump House @ SPRR/Paseo Padre Pkwy
2009	BART Extension Construction Trailer and Temporary Power Service
2011	Nature Learning Cener (new structure & location)
2012	Catholic Protection Station for Paseo Padre Pkwy Grade Separation BART Ventilation Structures ("LES" & "CPS") and Traction Power Substation ("SPP")
2013	Addresses for meter locations (serving Central Park Well # 1 and Central Park Well # 2) and Pump House (west of Nature Learning Center and north of Water Park to contain meters for Nature Learning Center/5-Palms & Babbling Brook Restrooms and Water Park/Babbling Brook Well).
2014	Address for utility meter providing power to pole lights located in parking lot on Stevenson Blvd (near Civic Center Dr / between the Library and Police Building).



**FOR ADDRESSING PURPOSES ONLY - FREMONT CENTRAL PARK**  
 SP72-0299 6/5/2014 RW