

ADDRESS CHRONOLOGY

- Address plan for TR 8348: 8/7/2018 (RW)

LOCATIONAL MAP

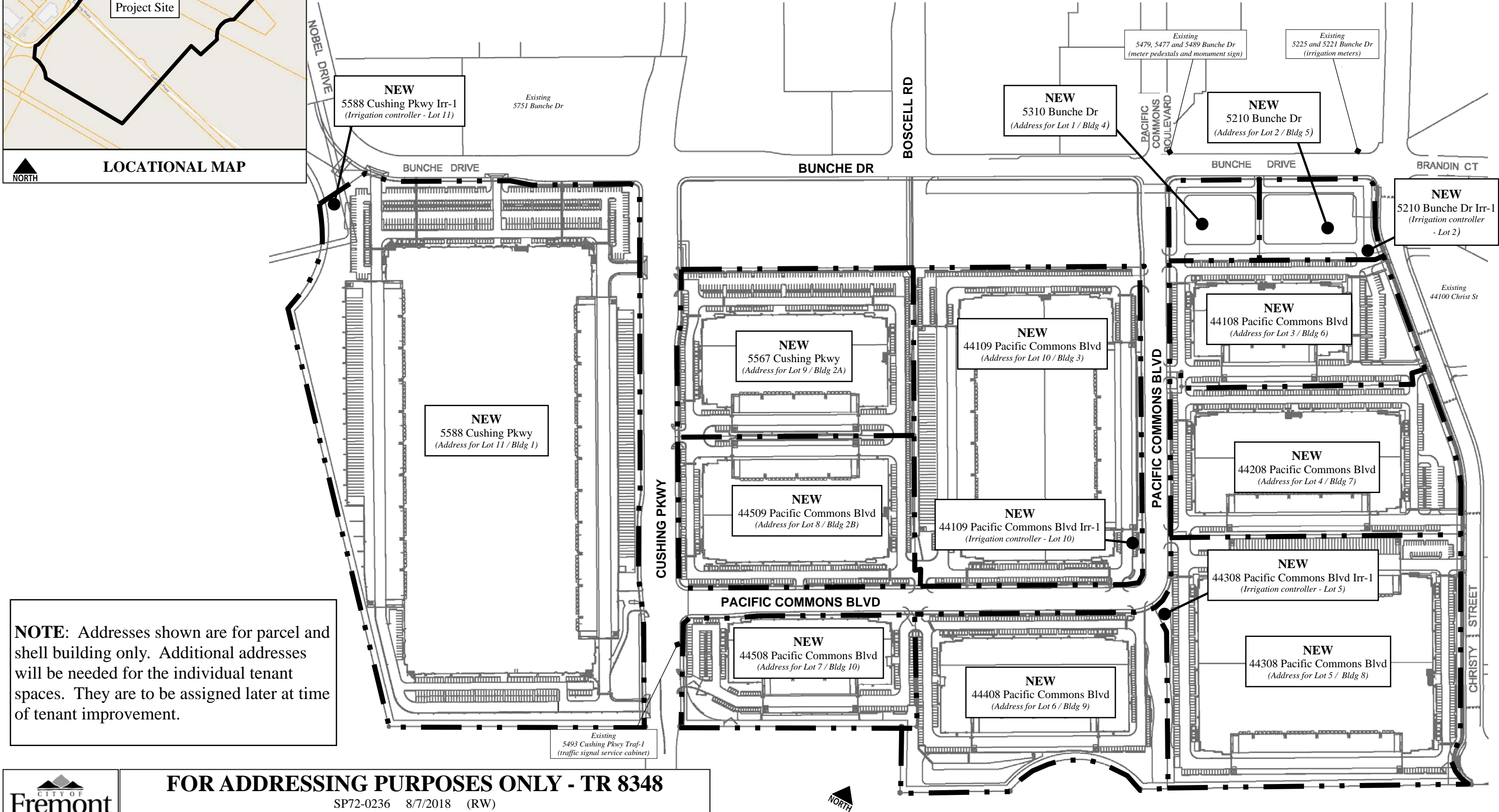

NOTE: Addresses shown are for parcel and shell building only. Additional addresses will be needed for the individual tenant spaces. They are to be assigned later at time of tenant improvement.



FOR ADDRESSING PURPOSES ONLY - TR 8348

SP72-0236 8/7/2018 (RW)

