



Date: March 1, 2019

To: Taotao Zhao  
 Taozhao Property Corp.  
 2175 Decoto Rd #120  
 Union City, CA 94587  
 AND  
 Fahed Habayeb  
 Planning & Design  
 686 Stockton Ave  
 San Jose, CA 95126

Requestor: TWONG  
 Discretionary Rev: SAM2014-00016; PLN2014-00362  
 Permitting File#: BLD2017-07032; BLD2017-07034;  
 BLD2017-07036; BLD2017-07038  
 SP#: 60-0162  
 APN#: 501 053604802; 501 053604902  
**Zip Code: 94536**  
 Fire ESZ | Box/S-Dist: 06-451 | 6-1/88B2  
**Address For:** Residential Development

Re: Addresses for residential development – Tract 7694 (Aurora Spring)

To Whom It May Concern:

In response to your request for addresses needed for a new residential development, a total of twenty-two (22) new addresses have been assigned. And, as part of this addressing action, two (2) existing addresses (i.e. 4141 & 4155 Central Ave) have been rescinded. For a full inventory and description of the addresses, please refer to Table “A” for a list of authorized addresses. Table “B” contains a listing of rescinded addresses. The enclosed Addressing Plan illustrates the proper use and placement of the new addresses.

**Electronic copies of this letter and documentation will be posted to the City’s web site at [http://gis.ci.fremont.ca.us/addr/addr\\_proj.cfm](http://gis.ci.fremont.ca.us/addr/addr_proj.cfm) within 10 business days. The files will be stored under SP60-0162.**

**Documents available on Web Site:**

X	Notification Letter	x	Address Table
X	Address Plan (map)		G.I.S. Layer
	AutoCAD Drawing		

In accordance with Title 15 (Buildings and Construction) Chapter 15.55 (House Numbering) of the Fremont Municipal Code, this letter serves as the notice of the addressing action affecting your property. The new address must be in use within ten (10) days of the receipt of this letter. For information on the size and location of address numbers on a building, please refer to the enclosed information sheet titled “ADDRESSING – Property Owner Responsibilities” and to Chapter 15.50 (Building Security) of the Title 15 (Buildings and Construction).

You will need to update your address records and outside address numbers as soon as possible for the purpose of rapid identification of your property in the event of an emergency. Any occupants and

property owner of this parcel should review and update their records that are registered with the City (such as for building permit and/or business tax purposes). And, by copy of this letter, we are notifying the below-listed agencies and utility companies. However, be aware that some agencies may not update their records until notified by the property owner. Therefore, it is your responsibility to make sure that the appropriate agencies or businesses acknowledge the correct addresses.

**If you have any questions concerning this matter, please contact Ron Chan at (phone) 510-494-4832 or (e-mail) rchan@fremont.gov.**

Sincerely,

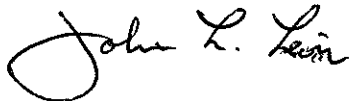

John L. Leon  
GIS and Addressing Manager (Interim)

Enclosures (hardcopy/paper): Address Plan - map (1) and Property Owner Responsibilities Information Sheet.

cc: **Paper copy mailed to:**

Alameda County Assessor's Office  
Alameda County Regional Emergency Communication Center - Dublin (Joshua Harris)  
Alameda County Registrar of Voters  
Alameda County Water District (2)  
Alameda County 911 (Coordinator)  
Alameda County Main Post Office (Donna Canalin)  
Republic Services (Customer Service Manager)  
Fremont Main Post Office (David Epps) – zip code area 94536 / 94537 / 94555  
US Postal Service / AMS (Veronica Chavez)  
Fremont Unified School District (Facilities Director)  
Lynx Technologies  
Pacific Gas & Electric (Emmanuel Veneracion / Service Planning Dept.) (2)  
AT&T – Engineering  
Union Sanitary District (2)

**Sent via e-mail:**

Alameda County Assessor's Office  
AT&T – Database Center / SLIC  
Cooperative Strategies/Dolinka Group (Andrew Bishop)  
Fremont Community Development – Building & Safety (Gary West)  
Fremont Community Development – Fire & Life Safety (Howard Hancock)  
Fremont Fire – Operations (Amiel Thurston, Rick Cory & Jennifer Seetho)  
Fremont Fire – Prevention (Jay Swardenski)  
Fremont Plans & Permits  
Fremont Environmental Services (Lori Marra)  
Fremont GIS (Ruby Wun)

### LOCATIONAL MAP

(For reference only – see official addressing map for actual/correct address)

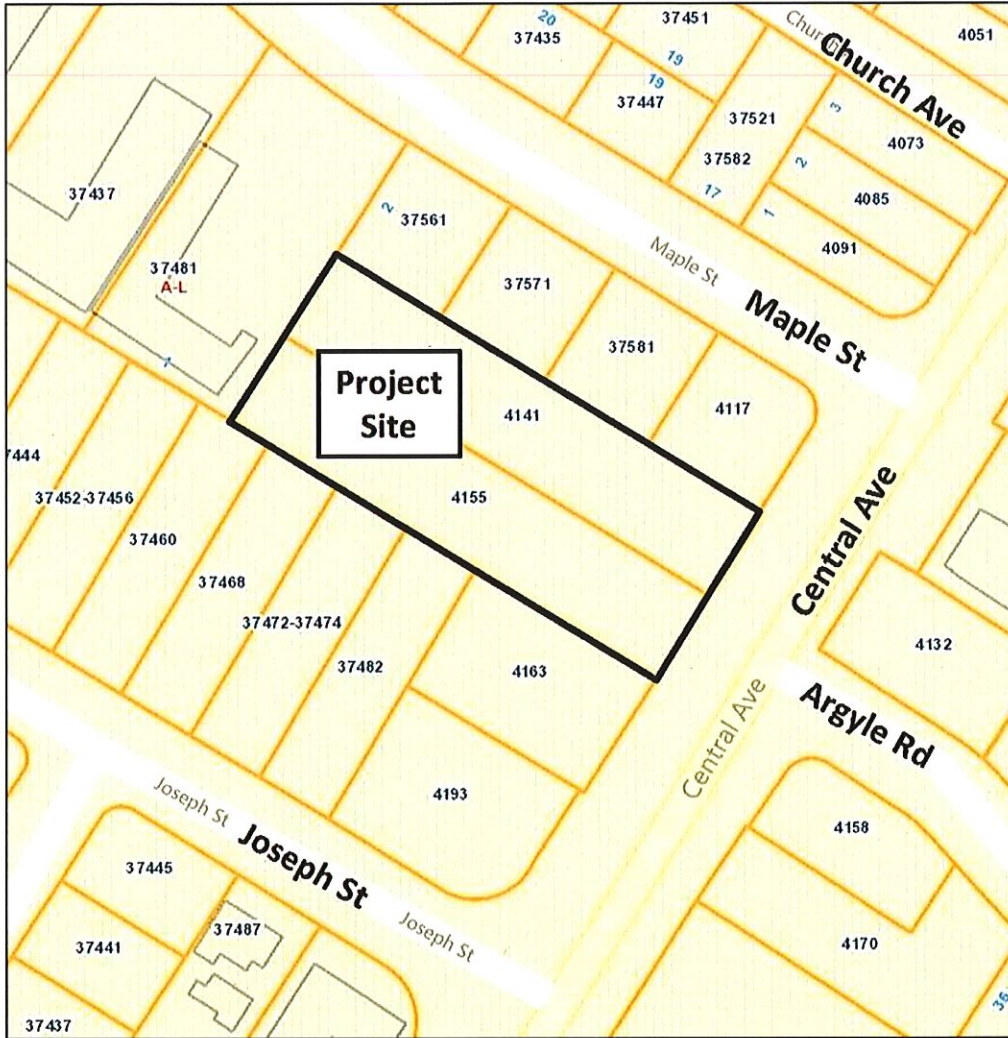

**TABLE A: Authorized Addresses**

Record	Address No	Street Name	Unit No	Zip Code	Bldg	Floor	Subdivision No.	Land Lot	Condo Lot	Address Type	Address Status
1	37571	Orchid Cmn		94536			TR 7694	Lot 1		Townhouse	Assigned
2	37561	Orchid Cmn		94536			TR 7694	Lot 2		Townhouse	Assigned
3	37551	Orchid Cmn		94536			TR 7694	Lot 3		Townhouse	Assigned
4	37541	Orchid Cmn		94536			TR 7694	Lot 4		Townhouse	Assigned
5	37531	Orchid Cmn		94536			TR 7694	Lot 5		Townhouse	Assigned
6	37521	Orchid Cmn		94536			TR 7694	Lot 6		Townhouse	Assigned
7	37511	Orchid Cmn		94536			TR 7694	Lot 7		Townhouse	Assigned
8	37501	Orchid Cmn		94536			TR 7694	Lot 8		Townhouse	Assigned
9	37500	Orchid Cmn		94536			TR 7694	Lot 9		Townhouse	Assigned
10	37510	Orchid Cmn		94536			TR 7694	Lot 10		Townhouse	Assigned
11	37520	Orchid Cmn		94536			TR 7694	Lot 11		Townhouse	Assigned
12	37540	Orchid Cmn		94536			TR 7694	Lot 12		Townhouse	Assigned
13	37550	Orchid Cmn		94536			TR 7694	Lot 13		Townhouse	Assigned
14	37560	Orchid Cmn		94536			TR 7694	Lot 14		Townhouse	Assigned
15	37570	Orchid Cmn		94536			TR 7694	Lot 15		Townhouse	Assigned
16	37530	Orchid Cmn		94536			TR 7694	Parcel A		Common Area	Assigned
17	37530	Orchid Cmn	Meter-1	94536			TR 7694	Parcel A		Utility	Assigned
18	37530	Orchid Cmn	Meter-2	94536			TR 7694	Parcel A		Utility	Assigned
19	37530	Orchid Cmn	Meter-3	94536			TR 7694	Parcel A		Utility	Assigned
20	37530	Orchid Cmn	Meter-4	94536			TR 7694	Parcel A		Utility	Assigned
21	37530	Orchid Cmn	Sign-1	94536			TR 7694	Parcel A		Utility	Assigned
22	37530	Orchid Cmn	Sign-2	94536			TR 7694	Parcel A		Utility	Assigned

**TABLE B: Rescinded Addresses**

Record	Address No.	Street Name	Unit No.	Zip Code	Bldg	Floor	Subdivision No.	Land Lot	Condo Lot	Address Type	Address Status
1	4141	Central Ave		94536						Parcel	Rescinded
2	4155	Central Ave		94536						Parcel	Rescinded