

**LOCATIONAL MAP**

- ADDRESS CHRONOLOGY**
- Initial addressing at time of original development: 1984
  - Addressing of Accessory Dwelling Unit: 5/22/2019 (RW)

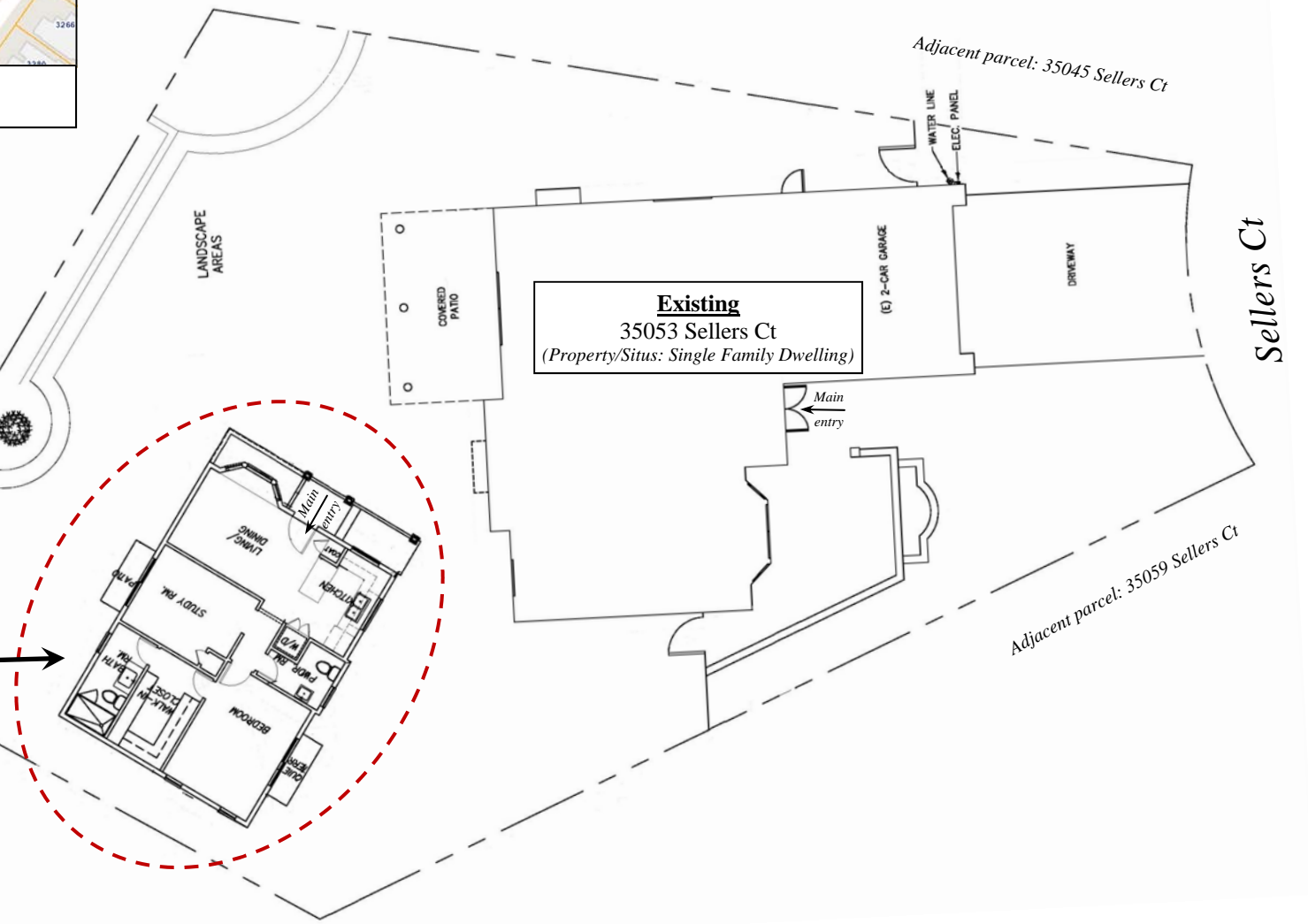

**NEW**  
35051 Sellers Ct  
(Accessory Dwelling Unit)



**FOR ADDRESSING PURPOSES ONLY**  
SP54-0077 5/22/2019 (RW)