



ADDRESS CHRONOLOGY

- Initial addressing at time of original development: 1970
- Assignment of address for Secondary Dwelling Unit: 3/30/2015 (RW)

LEGEND:

- Front door location
- Path to new secondary dwelling unit (generalized)
- ⌈ Secondary dwelling unit

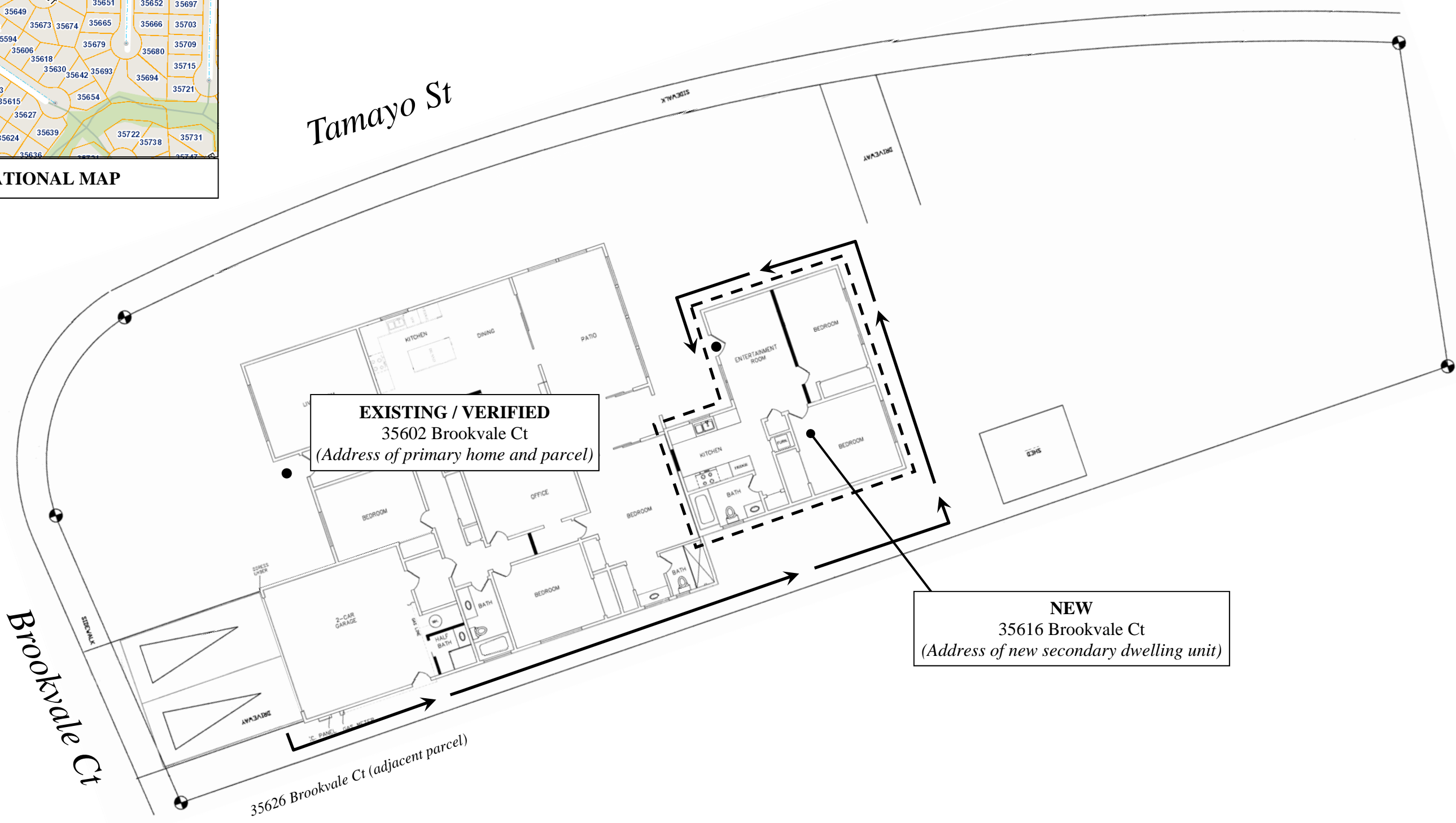

EXISTING / VERIFIED
 35602 Brookvale Ct
(Address of primary home and parcel)

NEW
 35616 Brookvale Ct
(Address of new secondary dwelling unit)



FOR ADDRESSING PURPOSES ONLY
 SP54-0064 3/30/2015 (RW)