

ADDRESS CHRONOLOGY - 6591 Dumbarton Circle

- Initial addressing at time of original development: 1/1/97 (ME)
- Address correction: 6/27/2000 (HN)
- Relocation of existing address (6591 Dumbarton Cir) and assignment of new address (6587 Dumbarton Cir): 5/6/2010 (RW)

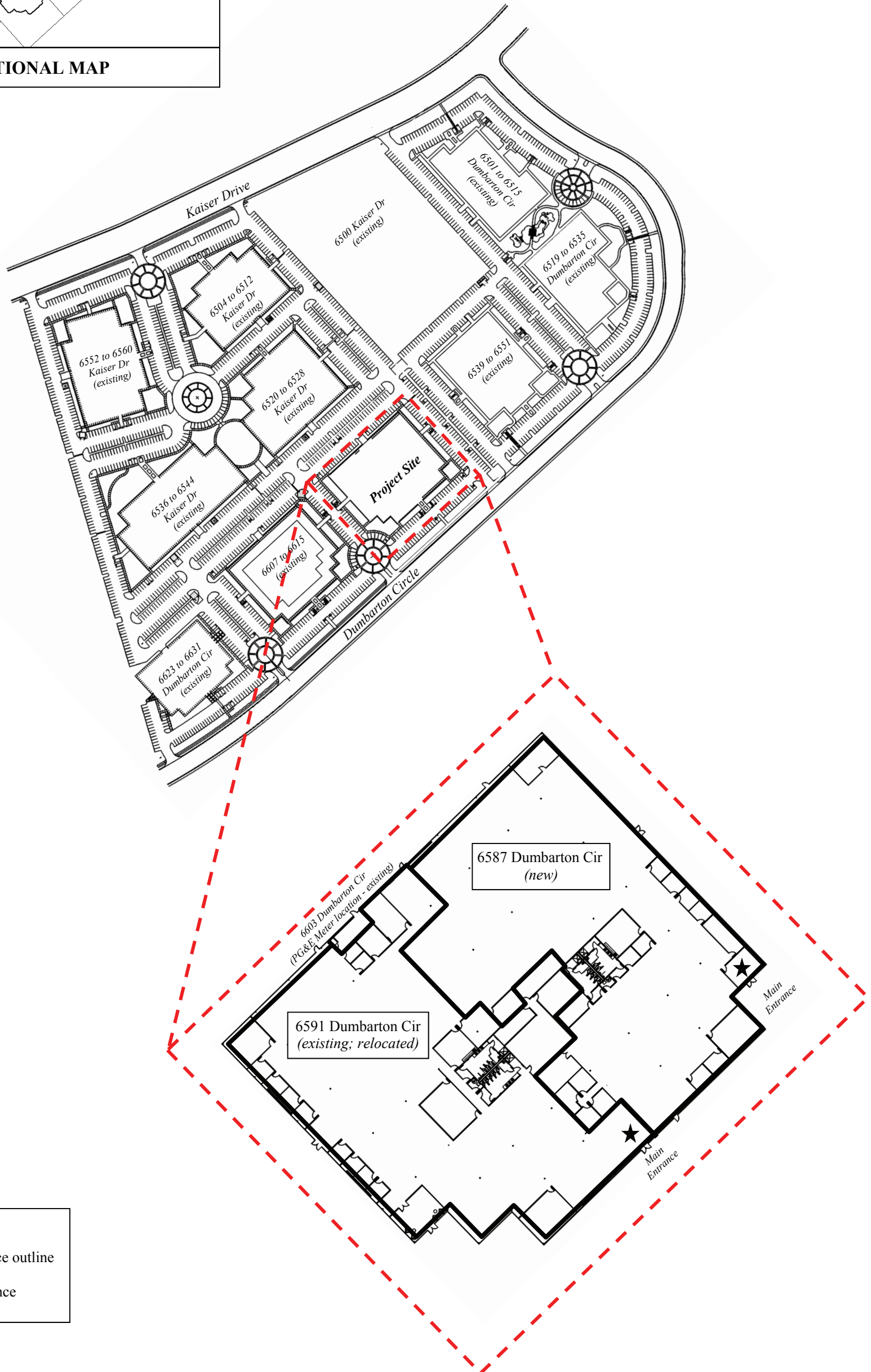

LEGEND:

- Tenant Space outline
- ★ Main Entrance